

## Resin Toilet Seat

Thank you for purchasing this Croydex product. Please follow the fixing and care instructions to ensure your Resin toilet seat is fitted safely and retains its high quality finish. Please retain this leaflet for future reference.

This installation guide applies to the following products:

**WL400322H Fenton Toilet Seat**

**WL400222H Logan Toilet Seat**

### Tools Required - Not Supplied

Cross head screwdriver; Hacksaw (Optional)

KEEP DIY TOOLS OUT OF THE REACH OF CHILDREN

### Home Safety Advice

- Do not strike the product with hard or sharp objects.
- Do not stand on the lid or the seat.
- Avoid slamming the lid or the seat.

### Product Care

- To retain the best quality finish, clean product regularly with a soft cloth and mild detergents.
- Do not use abrasive or chemical cleaners as these may damage the product.
- Spray cleaning liquids onto the cloth and not directly onto the product.

#### Fixing Pack Contents (Not to scale)

**A** - Hinge Base x 2

**B** - Stainless Steel Cover x 2

**C** - Plastic Plug x 2

**D** - Fixing Bolt x 2

**E** - Hex allen key x 1

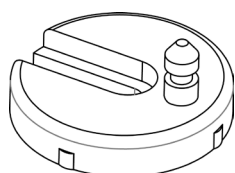

**A**

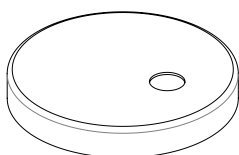

**B**

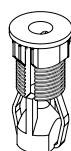

**C**

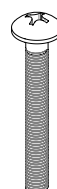

**D**



**E**

## Toilet seat fitting guide

1. Push a plastic plug into each of the fixing holes on the top of the toilet pan. Fig 1
2. Loosely fix the hinge bases to the toilet pan using the fixing bolts and a cross head screwdriver. Do not fully tighten at this stage, the hinge base must be loose enough on the toilet pan so its position can be adjusted in the next step but tight enough so once it is adjusted it doesn't easily move. Fig 2
3. Clip the toilet seat onto the hinge bases. There are two holes on the underside of the hinge barrels on the toilet seat, line these holes up with the two upright pins on the hinge bases and push down firmly. Fig 3. It may be necessary to release the grub-screw slightly to help secure the seat down onto the pins.
4. Align the toilet seat with the toilet pan by rotating the hinge bases, ensuring that the seat is far enough forward on the pan to allow the lid and seat to stay up when lifted to an upright position. Once the toilet seat is in its desired position carefully lift the seat off and finish tightening the fixing bolts. Replace the seat onto the hinge base and then tighten the grub-screw with the allen key provided. Fig 4.

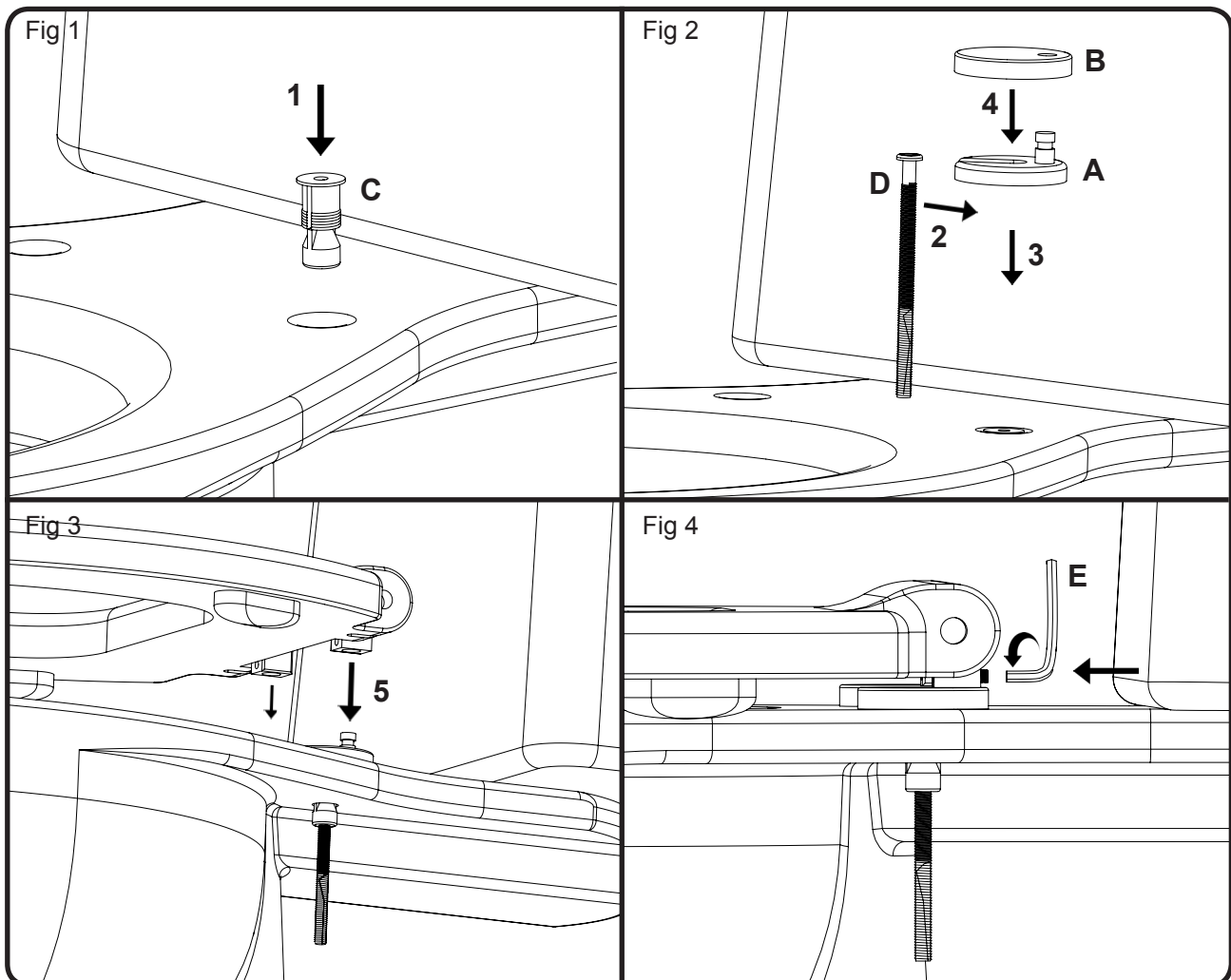

For details of the other items in the Croydex range please visit our website: [www.croydex.com](http://www.croydex.com)

Croydex, Central Way, Andover, Hampshire, SP10 5AW, UK  
Tel: +44 (0) 1264 365881 Fax: +44 (0) 1264 356437  
E-mail: [info@croydex.co.uk](mailto:info@croydex.co.uk)